

Spare parts list – Tormek T-1

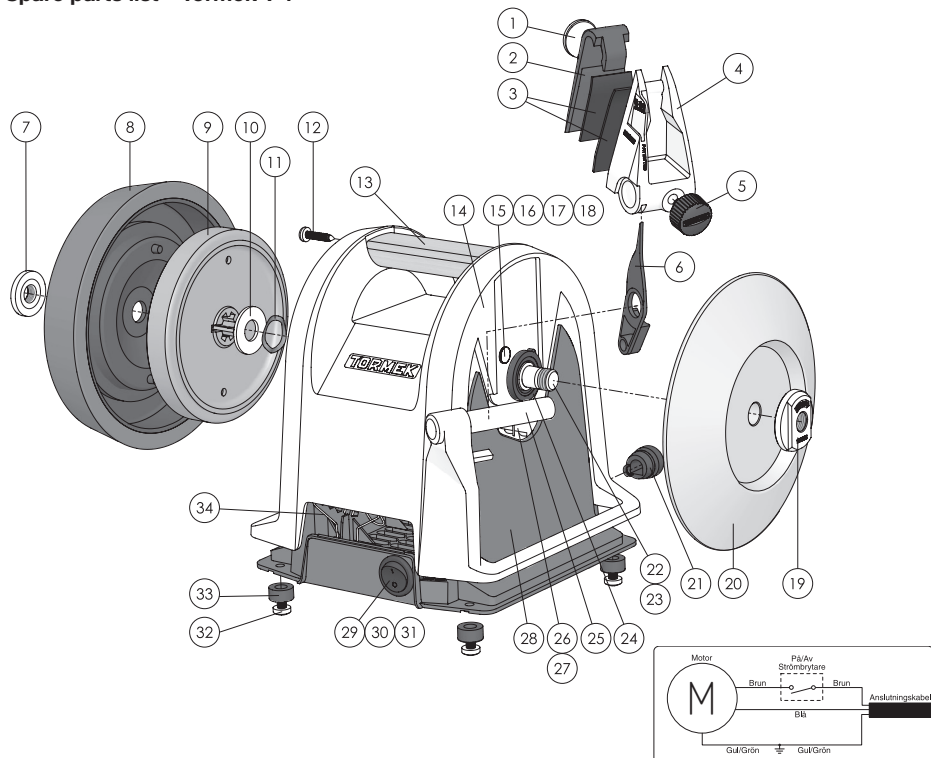

Pos	Designation	Quantity	Part no.
1	Magnet	1	5370
2	Clamp for the guide	1	3115
3	Knife Protection Pads	1+1	6040+6015
4	Zinc part for the guide	1	2015
5	Knob screw	1	1185
6	Indicator for the guide	1	3075
7	Honing wheel nut M12	1	0100
8	PW-160 Composite honing wheel	1	3670-07
9	Drive wheel	1	3208-07
10	Washer for drive wheel	1	5081
11	Wave washer	1	5410
12	Screw for handle	1	5025
13	Handle	1	0820
14	Housing	1	2550
15	Swing shaft	1	1030
16	Bushing for swing shaft*	3	3121
17	Spacer spring for the motor*	1	0520
18	Motor 80 W*	1	6095 (230V) 6105 (115V)
19	Grinding wheel nut M12 with left-hand thread	1	0060
20	Grinding wheel	1	6090
21	Grommet	1	6085
22	Main shaft	1	1025

Pos	Designation	Quantity	Part no.
23	Lock pin for drive wheel*	1	5071
24	Main shaft bearing	2	3061
25	Shaft	1	1420
26	Screw M4×8*	2	5600
27	Toothed lock washer*	2	5021
28	Lower section	1	3085
29	Power switch	1	6110
30	Inner wiring*	1	6100
31	Insulation sleeve*	3	3105
32	Screw M5×10	4	5590
33	Rubber foot	4	3095
34	Counterhold spring for motor	1	0515
35	Power cable rack*	1	6031 (EUR) 6041 (CH) 6043 (US) 6050 (JP) 6053 (GB) 6055 (AU) 6057 (ZA)

* Not shown in the drawing.